

材料:Material:

塑胶: LCP

端子: Contact:C2680

Plated Gold in Mating Area;

Tin On Solder Talls

外壳 Shell: SPCC

寿命测试: life test:

1500次, 插拔速度300次/小时

插入力MAX: 4.5Kgf Max.

拔出力MIN: 0.45Kgf Min.

盐雾测试: 24H

特性 Specifications:

电器 Electrical:

接触阻抗:Contact Resistance

30 mΩ MAX

耐压 Dielectric Withstanding Voltage:

500V AC

绝缘阻抗:Insulation Resistance:

1000 MΩ MIN

Working temprayure:-30° TO +85°

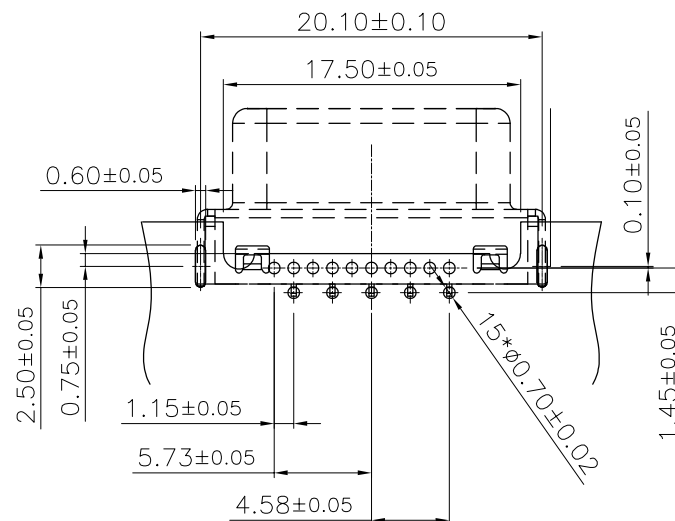

6			
5			
4			
3	Shell	SPCC	PLATING:Cu:80u",Ni:50u"
2	Terminal	C2680H	G/F
1	Housing	LCP	BLACK UL 94V-0
NO.	PART NAME	MATERIAL	DESCRIPTION

深圳市虹成电子有限公司

TITLE: VGA短体母座 正向CL=1.2mm

PART NO.	CUSTOMER NO (REV)	UNIT: mm
FILE NAME	SHEET: 1 of 1	SCALE: 1:1 A4

B	20'/09/10	新编号号发行	HQ	PAT	0	±0.20	DESIGN		
A	17'/06/26	更新图面	Wyl	Dave	0.0	±0.15		CHECK	
O	11'/04/26	NEW	captain	captain	0.00	±0.10	APPRO.		
REV	DATE	DESCRIPTION	NAME	APPRO.	GENERAL TOLERANCE UNLESS OTHERWISE NOTED			APPRO.	